

PANEL FASTENERS

HUCKTAINER® PANEL FASTENERS

HUCKTAINER® PANEL FASTENERS

- Designed to meet the requirements of the truck body and trailer industries, Hucktainers provide a high strength, vibration-resistant clamp.
- These fasteners will not crush or craze FRP (Fiberglass Reinforced Plywood) panels and are available with encapsulated heads for maximum corrosion resistance.
- PVC foam sealant under the head of the pin creates a weatherproof seal.
- Tamper proof uniform clamp.
- Pin-Lock is a nylon "star" that retains the pin in the hole prior to installation and are included on the Hucktainers with the "PL" suffix on the Huck reference number.
- Note: Only wide bearing pin (HLPE) and/or wide bearing sleeve (HLPS) should be used directly against FRP.

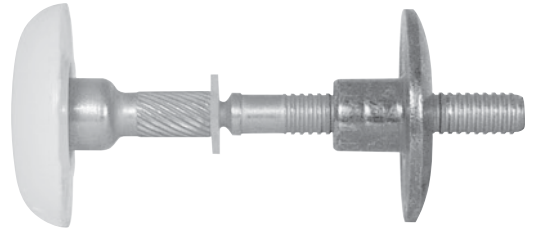

STANDARD LOW PROFILE HEAD (NON-ENCAPSULATED)

PART No.	HUCK CROSS REFERENCE	GRIP RANGE MIN. – MAX.	HOLE SIZE	COLOR	A	B	C	QTY.
78315	HLPP-R12-16	.937 – 1.062	.405 – .421	Zinc	0.999	2.607	0.470	50

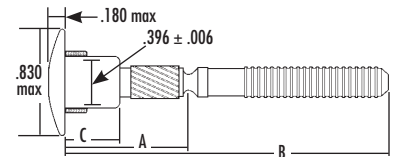

MEDIUM BEARING ENCAPSULATE HEAD

- Including Pin-Lock pin retainer.

PART No.	HUCK CROSS REFERENCE	GRIP RANGE MIN. – MAX.	HOLE SIZE	COLOR	A	B	D	QTY.
78321	HLPMG-R12-10PL	.562 – .687	.405 – .421	Gray	0.624	2.232	0.015	50
78322	HLPMG-R12-12PL	.687 – .812	.405 – .421	Gray	0.749	2.357	0.145	50
78323	HLPMG-R12-14PL	.812 – .937	.405 – .421	Gray	0.874	2.482	2.700	50

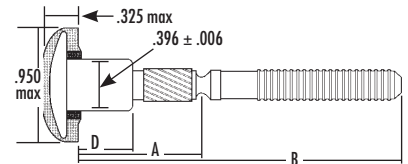

WIDE BEARING ENCAPSULATE HEAD

- Including Pin-Lock pin retainer.

PART No.	HUCK CROSS REFERENCE	GRIP RANGE MIN. – MAX.	HOLE SIZE	COLOR	A	B	D	QTY.
78332-4	HLPEW-R12-13PL	.750 – .875	.405 – .421	White	0.812	2.420	0.145	400
78333	HLPEW-R12-14PL	.812 – .937	.405 – .421	White	0.874	2.482	0.270	50
78333-4	HLPEW-R12-14PL	.812 – .937	.405 – .421	White	0.874	2.482	0.270	400

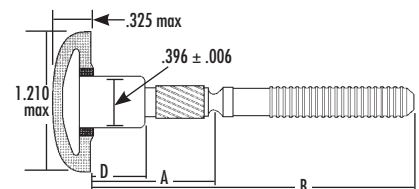

BEARING SLEEVES

PART No.	HUCK CROSS REFERENCE	DESCRIPTION	MAX HEAD DIAMETER	MAX HEAD THICKNESS	SLEEVE DIAMETER	SLEEVE THICKNESS	FLANGE	HOLE SIZE	METAL	QTY.
78302	HLPSM-R12	Medium Bearing Sleeve	.940	.150	.399 ± .006	.375 ± .020	.940	.400	Steel	50
78302-4	HLPSM-R12	Medium Bearing Sleeve	.940	.150	.399 ± .006	.399 ± .006	.940	.400	Steel	500
78303	HLPS-R12	Large Bearing Sleeve	1.160	.150	.399 ± .006	.375 ± .020	1.160	.400	Steel	50
78303-4	HLPS-R12	Large Bearing Sleeve	1.160	.150	.399 ± .006	.375 ± .020	1.160	.400	Steel	500

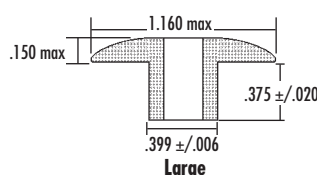
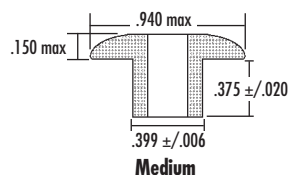
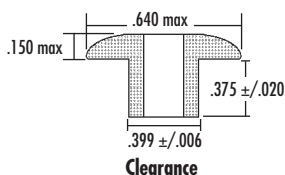

SEE PAGE C19

Huck Rivet Installation Tools